

WISCASSET MUNICIPAL AIRPORT

MASTER PLAN UPDATE WISCASSET, MAINE

A.I.P. PROJECT NO. 3-23-0049-07

FEBRUARY 2001

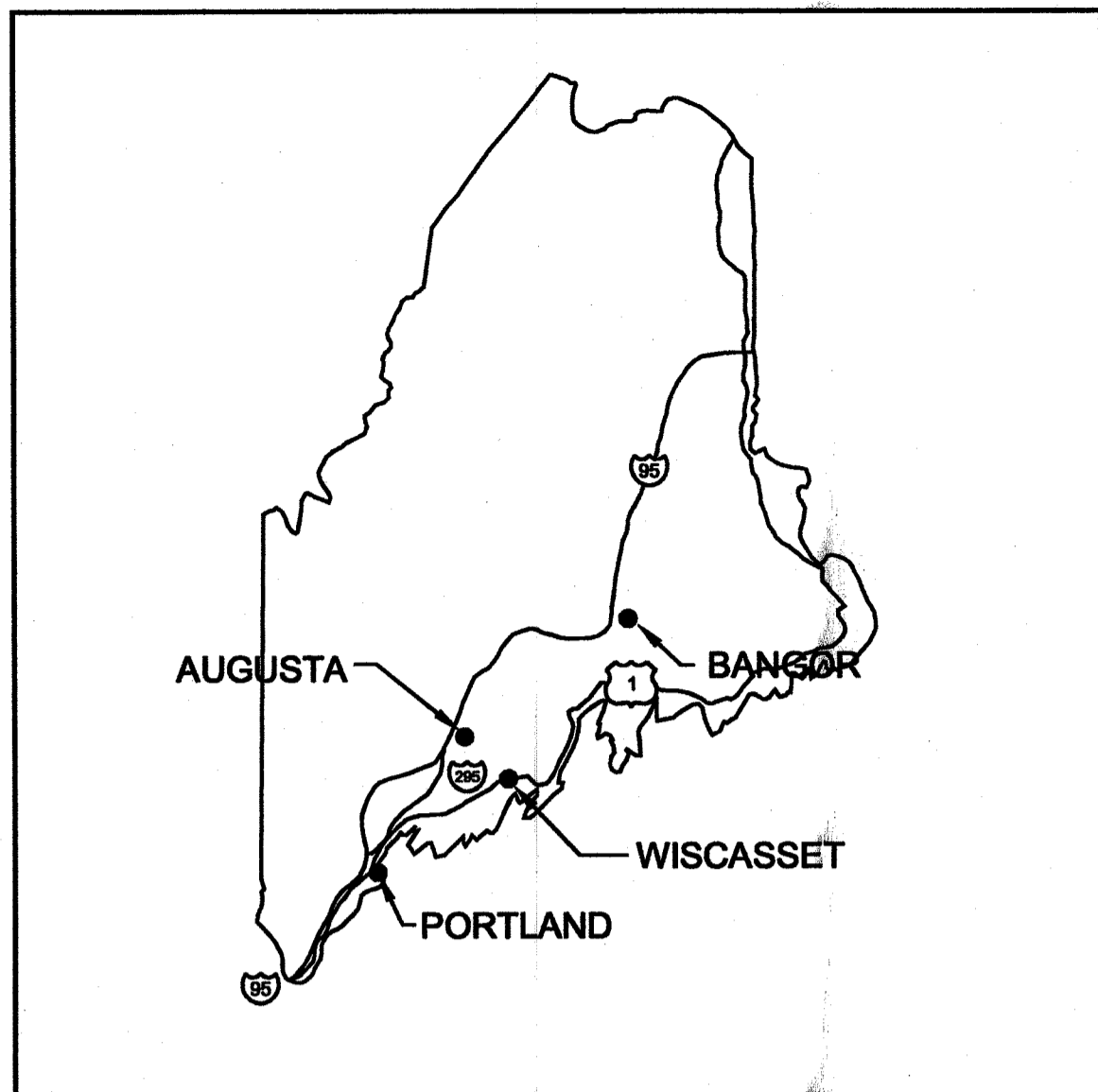

LOCATION MAP



VICINITY MAP

SHEET	TITLE
1	TITLE SHEET
2	EXISTING AIRPORT FACILITIES PLAN
3	ULTIMATE AIRPORT LAYOUT PLAN
4	TERMINAL AREA PLAN
5	RUNWAY 25 APPROACH PLAN AND PROFILE
6	RUNWAY 7 APPROACH PLAN AND PROFILE
7	FAR PART 77 IMAGINARY SURFACES PLAN
8	LAND-USE PLAN

INDEX OF SHEETS

OFFICES:
VERMONT
Montpelier
N. Springfield
S. Burlington
Williston
NEW HAMPSHIRE
Manchester
NEW YORK
Newburgh
Pawling
Rochester
Saratoga Springs
MAINE
Portland
MASSACHUSETTS
Boston
Greenfield
Westford
FLORIDA
Port Charlotte
Sarasota



Portland, Maine
Tel. (207) 775-3211 • FAX (207) 775-6434
www.dufresne-henry.com

RUNWAY DATA	EXISTING
RUNWAY LENGTH	3,400'
RUNWAY WIDTH	75'
PAVEMENT STRENGTH	22,000 LBS. SINGLE WHEEL
APPROACH SURFACES	R/W 7: 20:1 NP (UTILITY) R/W 25: 20:1 NP (UTILITY)
RUNWAY MARKINGS	NON-PRECISION
RUNWAY LIGHTING	MIRL
RUNWAY NAVAIDS	R/W 7: PAPI-4R R/W 25: PAPI-4L, REILS
EFFECTIVE GRADIENT	0.43%
RUNWAY END ELEVATIONS	R/W 7: 71.4' MSL R/W 25: 56.9' MSL
RUNWAY END COORDINATES	R/W 7: 43°57'30.676"N 69°43'03.468"W R/W 25: 43°57'51.458"N 69°42'26.999"W
RUNWAY SAFETY AREA	150' X 300'
RUNWAY OBJECT FREE AREA	500' X 300'
TAXIWAY LIGHTING	MITLS
TAXIWAY MARKING	CENTERLINE, HOLDLINE
TAXIWAY OBJECT FREE AREA	131'

AIRPORT DATA	EXISTING
AIRPORT ELEVATION	71.4' MSL
AIRPORT REFERENCE POINT	LAT. 43°57'41.068"N LONG. 69°42'45.235"W
MEAN MAX. TEMP. (HOTTEST MO.)	78°F
DESIGN AIRCRAFT	BEECH KING AIR 90
FUEL AVAILABILITY	JET A & 100 LL
AIRPORT/TERRAIN NAVAIDS	AIRPORT BEACON, LIGHTED WINDCONE WITH SEGMENTED CIRCLE
AIRPORT REFERENCE CODE (ARC)	BII (UTILITY)

EXISTING	ON-AIRPORT BUILDINGS
①	ADMINISTRATION BUILDING
②	MAINTENANCE BUILDING
③	CONVENTIONAL HANGAR
④	CONVENTIONAL HANGAR

NOTE:
BUILDING RESTRICTION LINE (BRL) WAS ESTABLISHED IN ACCORDANCE WITH FAA DESIGN AND FAR PART 77 CRITERIA. ITS LOCATION UTILIZES A 20 FT. VERTICAL OBJECT HEIGHT. THE BRL LOCATION MAY CHANGE DUE TO GROUND CONTOURS OR DIFFERENT OBJECT HEIGHTS, BUT ALWAYS IN ACCORDANCE WITH FAR PART 77 AND FAA DESIGN CRITERIA.

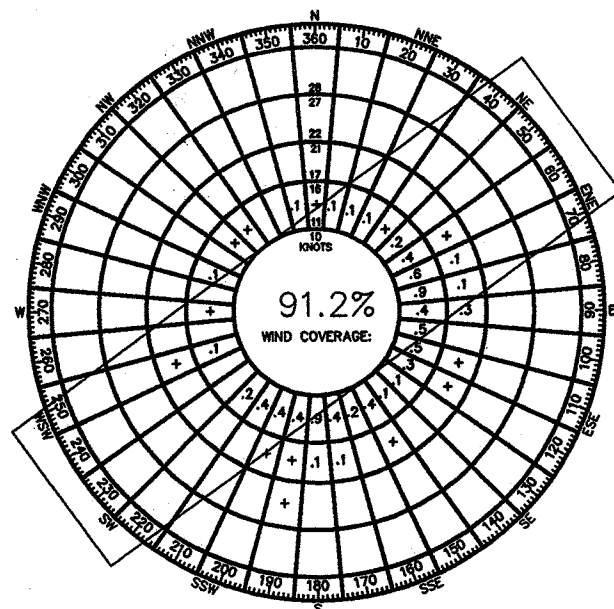
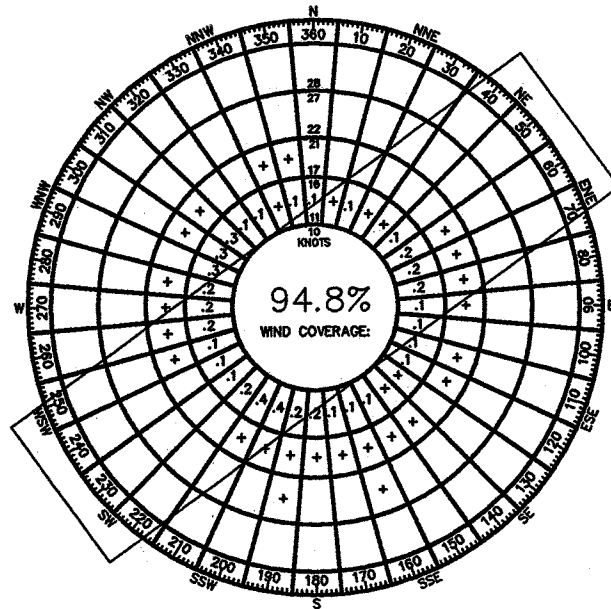

RUNWAYS	10.5-KNOT CROSSWIND	13-KNOT CROSSWIND	RUNWAYS	10.5-KNOT CROSSWIND	13-KNOT CROSSWIND
7-25	98.09%	99.16%	7-25	98.65%	98.60%

PERIOD: 1995 - 1998
LOCATION: WISCASSET MUNICIPAL AIRPORT
WISCASSET, MAINE
SOURCE: NATIONAL CLIMATIC DATA CENTER
ASHEVILLE, NC

LEGEND	EXISTING
AIRPORT PROPERTY LINE	---
ADJUTERS' PROPERTY LINE	---
PAVEMENT	=====
TREE LINE	
AVIGATION EASEMENT LINE	-----
FENCE LINE	-----
BUILDINGS	□
UTILITY POLE	○
REIL	○
PAPI	○
WIND CONE	○
LIGHTED WIND CONE WITH SEGMENTED CIRCLE	○
OBJECT-FREE ZONE (OFZ)	-----
OBJECT-FREE AREA (OFA)	-----
RUNWAY SAFETY AREA (RSA)	-----
BUILDING RESTRICTION LINE (BRL)	-----
WETLANDS (DELINEATED)	-----

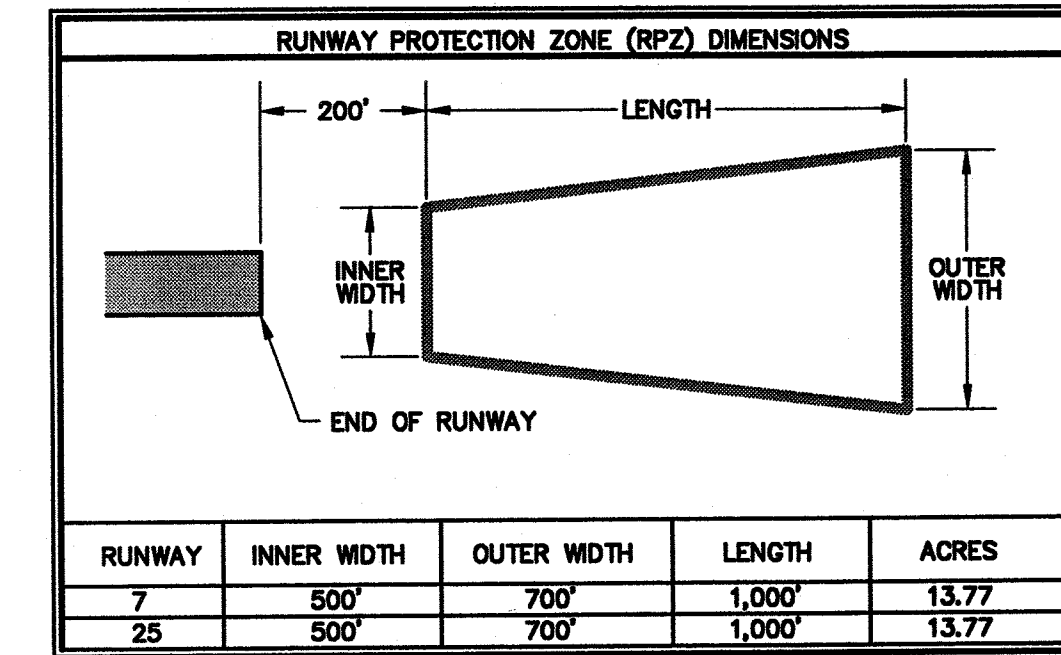

17.4' SCALED FROM NEW YORK SECTIONAL CHART, 62nd EDITION, NOV. 30, 2000

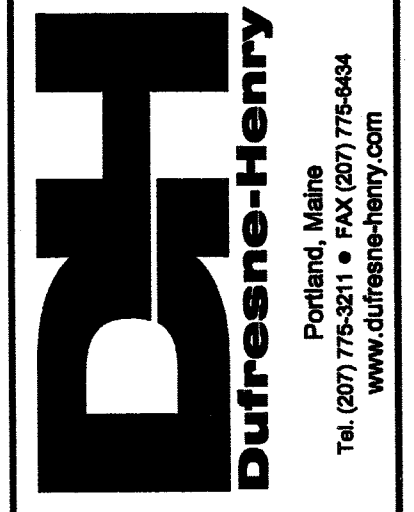
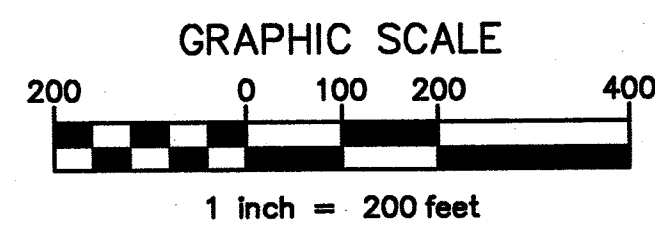
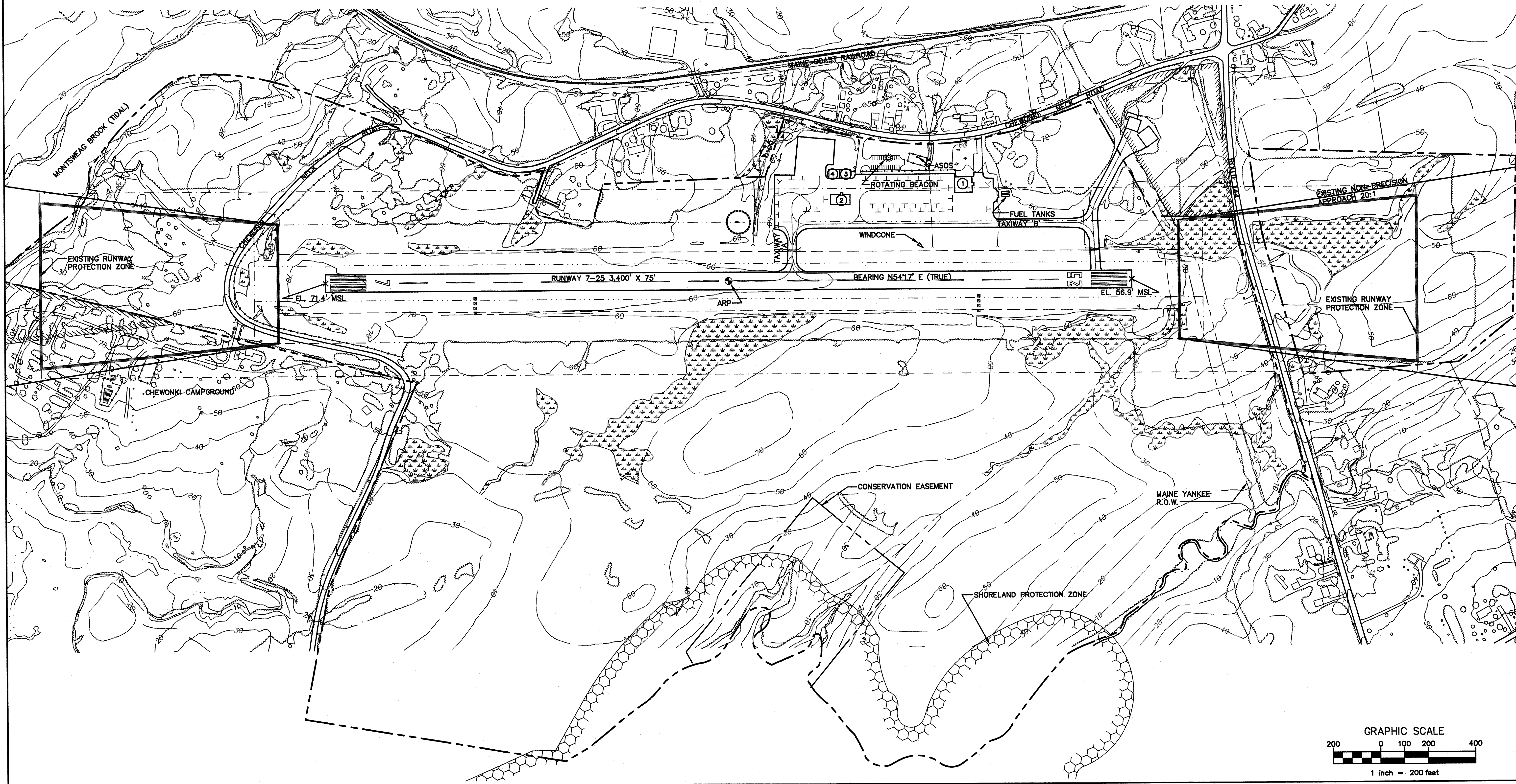

Rev.	Description	By	Date

WISCASSET MUNICIPAL AIRPORT
AIP NO. 3-23-0049-07

EXISTING AIRPORT FACILITIES PLAN

WISCASSET

Project No.	8180045
Proj. Manager	JEG
Proj. Designer	JEG
Drawn By	MRS
Checked By	JEG
Scale	1" = 200'
Approved	JMW
Date	02/20/01

RUNWAY DATA	EXISTING	ULTIMATE
RUNWAY LENGTH	3,400'	SAME
RUNWAY WIDTH	75'	SAME
PAVEMENT STRENGTH	22,000 LBS. SINGLE WHEEL	30,000 LBS. SINGLE WHEEL
APPROACH SURFACES	R/W 7: 20:1 NP (UTILITY) R/W 25: 20:1 NP (UTILITY)	SAME
RUNWAY MARKINGS	NON-PRECISION	SAME
RUNWAY LIGHTING	MIRL	SAME
RUNWAY NAVAIDS	R/W 7: PAPI-4R R/W 25: PAPI-4L, REILS	R/W 7: SAME R/W 25: SAME
EFFECTIVE GRADIENT	0.43%	SAME
RUNWAY END ELEVATIONS	R/W 7: 71.4' MSL R/W 25: 56.9' MSL	R/W 7: SAME R/W 25: SAME
RUNWAY END COORDINATES	R/W 7: 43° 57' 30" N 89° 43' 03" W R/W 25: 43° 57' 51" N 89° 42' 28" W	R/W 7: SAME R/W 25: SAME
RUNWAY SAFETY AREA	150' X 300'	SAME
RUNWAY OBJECT FREE AREA	500' X 300'	SAME
TAXIWAY LIGHTING	MITLS	SAME
TAXIWAY MARKING	CENTERLINE, HOLDLINE	SAME
TAXIWAY OBJECT FREE AREA	131'	SAME

AIRPORT DATA	EXISTING	ULTIMATE
AIRPORT ELEVATION	71.4' MSL	SAME
AIRPORT REFERENCE POINT	LAT. 43° 57' 41" N LONG. 69° 42' 45" W	SAME
MEAN MAX. TEMP. (HOTTEST MO.)	78°	SAME
DESIGN AIRCRAFT	BEECH KING AIR 90	SAME
FUEL AVAILABILITY	12,000 GALLONS	SAME
AIRPORT/TERMINAL NAVAIDS	AIRPORT BEACON, LIGHTED WINDCONE WITH SEGMENTED CIRCLE, GPS, NDB	SAME
AIRPORT REFERENCE CODE (ARC)	B-II (UTILITY)	SAME

NOTE: BUILDING RESTRICTION LINE (BRL) WAS ESTABLISHED IN ACCORDANCE WITH FAA DESIGN AND FAR PART 77 CRITERIA. ITS LOCATION UTILIZES A 20 FT. VERTICAL OBJECT HEIGHT. THE BRL LOCATION MAY CHANGE DUE TO GROUND CONTOURS OR DIFFERENT OBJECT HEIGHTS, BUT ALWAYS IN ACCORDANCE WITH FAR PART 77 AND FAA DESIGN CRITERIA.

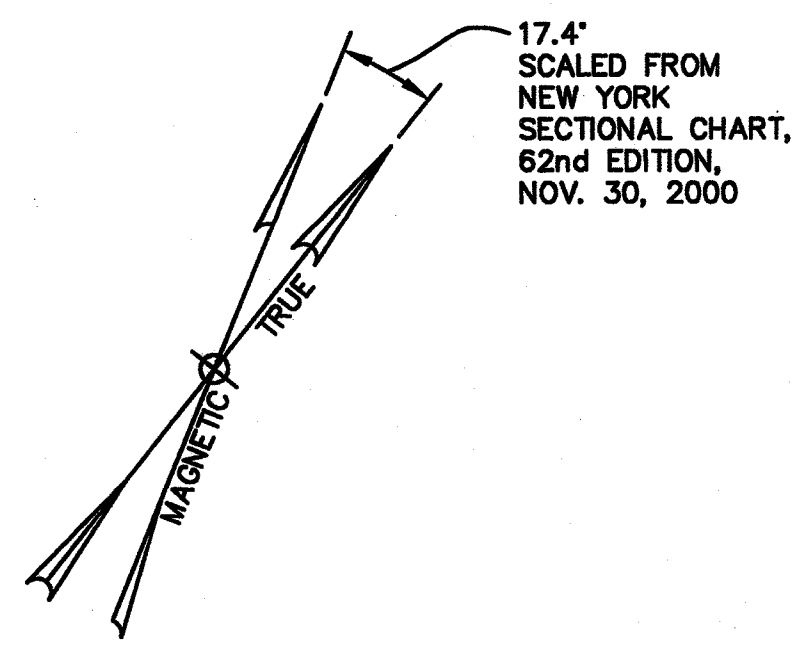

LEGEND	EXISTING	ULTIMATE
AIRPORT PROPERTY LINE	---	---
ADJUTERS' PROPERTY LINE	---	SAME
PAVEMENT	---	---
TREE LINE	---	---
AVIGATION EASEMENT LINE	---	SAME
FENCE LINE	---	---
BUILDINGS	---	---
UTILITY POLE	---	SAME
REIL	---	SAME
PAPI	---	SAME
LIGHTED WIND CONE	---	---
LIGHTED WIND CONE SEGMENTED CIRCLE	---	---
OBJECT-FREE ZONE (OFZ)	---	SAME
OBJECT-FREE AREA (OFA)	---	SAME
RUNWAY SAFETY AREA (RSA)	---	SAME
BUILDING RESTRICTION LINE (BRL)	---	SAME
WETLANDS (DELINEATED)	---	SAME

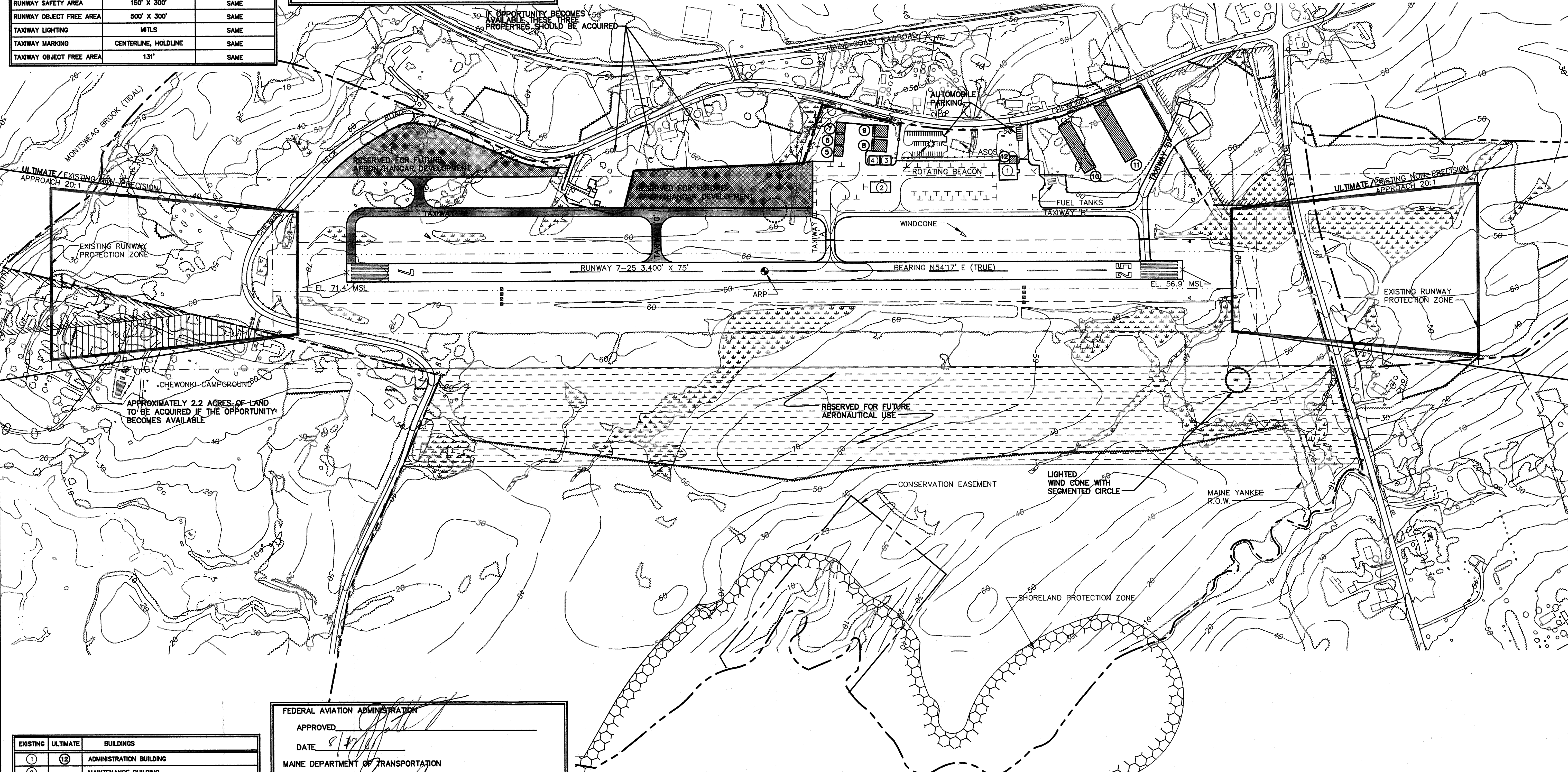
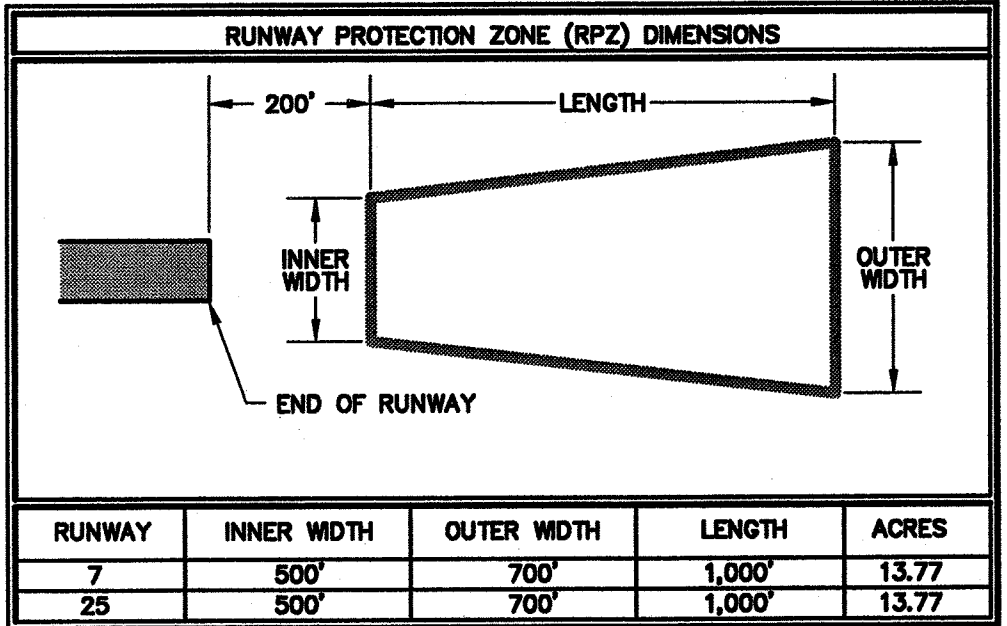

EXISTING	ULTIMATE	BUILDINGS
1	12	ADMINISTRATION BUILDING
2		MAINTENANCE BUILDING
3		CONVENTIONAL HANGAR
4		CONVENTIONAL HANGAR
	5	CONVENTIONAL HANGAR
	6	CONVENTIONAL HANGAR
	7	CONVENTIONAL HANGAR
	8	CONVENTIONAL HANGAR
	9	CONVENTIONAL HANGAR
	10	T-HANGARS
	11	T-HANGARS

FEDERAL AVIATION ADMINISTRATION
 APPROVED: [Signature]
 DATE: 8/17/01

MAINE DEPARTMENT OF TRANSPORTATION
 APPROVED: [Signature]
 DATE: 7-6-01

TOWN OF WISCASSET
 APPROVED: [Signature]
 APPROVED: [Signature]
 APPROVED: [Signature]
 DATE: June 19, 2001

DESCRIPTION	STANDARD	EXISTING/PLANNED	REMARKS	DATE APPROVED
NON-PRECISION APPROACH SURFACE ON RUNWAYS 7 AND 25	34:1	20:1/20:1	THIS 20:1 SLOPE IS USED BASED ON TERPS REQUIREMENTS	

CERTIFICATION:
 I HEREBY CERTIFY THAT ALL AIRPORT ELEMENTS SHOWN ON THIS AIP ARE IN ACCORDANCE WITH CRITERIA CONTAINED IN THE CURRENT EDITION OF FAA ADVISORY CIRCULAR 150/5300 13 EXCEPT AS NOTED IN THE TABLE.

NAME: _____ DATE: _____
 PRINTED NAME/TITLE: _____

CONSTRUCTION NOTICE REQUIREMENT
 TO PROTECT OPERATIONAL SAFETY AND FUTURE DEVELOPMENT, ALL PROPOSED CONSTRUCTION ON THE AIRPORT MUST BE COORDINATED BY THE AIRPORT OWNER WITH THE FAA AIRPORTS DISTRICT OFFICE PRIOR TO CONSTRUCTION. FAA'S REVIEW TAKES APPROXIMATELY 60 DAYS.

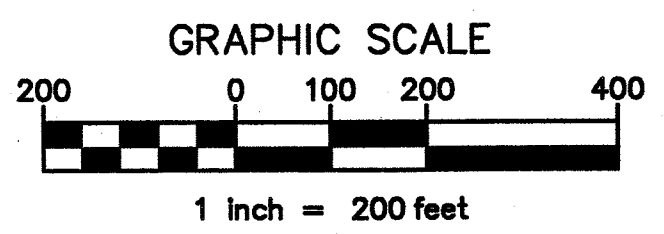

Dufresne-Henry Consulting Engineers
 Portland, ME 04101
 Tel: (207) 775-2211 • Fax: (207) 775-5484 • www.dhce.com

Project No. 8180045
 Proj. Manager: JEG
 Prof. Designer: JEG
 Drawn By: MRS
 Checked By: JEG
 Scale: 1" = 200'
 Approved: JMW
 Date: 02-2001

WISCASSET MUNICIPAL AIRPORT
 AIP NO. 3-23-0049-07

ULTIMATE AIRPORT LAYOUT PLAN

Sheet 3 of 8

EXISTING	ULTIMATE	ON-AIRPORT BUILDINGS
1	12	ADMINISTRATION BUILDING
2		MAINTENANCE BUILDING
3		HANGAR
4		HANGAR
5		CONVENTIONAL HANGAR
6		CONVENTIONAL HANGAR
7		CONVENTIONAL HANGAR
8		CONVENTIONAL HANGAR
9		CONVENTIONAL HANGAR
	10	NESTED T-HANGARS
	11	NESTED T-HANGARS

NOTE:
BUILDING RESTRICTION LINE (BRL) WAS ESTABLISHED IN ACCORDANCE WITH FAA DESIGN AND FAR PART 77 CRITERIA. ITS LOCATION UTILIZES A 20 FT. VERTICAL OBJECT HEIGHT. THE BRL LOCATION MAY CHANGE DUE TO GROUND CONTOURS OR DIFFERENT OBJECT HEIGHTS, BUT ALWAYS IN ACCORDANCE WITH FAR PART 77 AND FAA DESIGN CRITERIA.

LEGEND	EXISTING	ULTIMATE
AIRPORT PROPERTY LINE	---	---
ASPHALTERS' PROPERTY LINE	---	---
PAVEMENT	---	---
TREE LINE	---	---
AVIGATION EASEMENT LINE	---	---
FENCE LINE	---	---
BUILDINGS	---	---
UTILITY POLE	---	---
REL	---	---
PAPI	---	---
WIND SOCK	---	---
LIGHTED WIND CONE WITH SEGMENTED CIRCLE	---	---
OBJECT-FREE ZONE (OFZ)	---	---
OBJECT-FREE AREA (OFA)	---	---
RUNWAY SAFETY AREA (RSA)	---	---
BUILDING RESTRICTION LINE (BRL)	---	---
WETLANDS (DELINEATED)	---	---

17.4'
SCALED FROM
NEW YORK
SECTIONAL CHART,
62nd EDITION,
NOV. 30, 2000

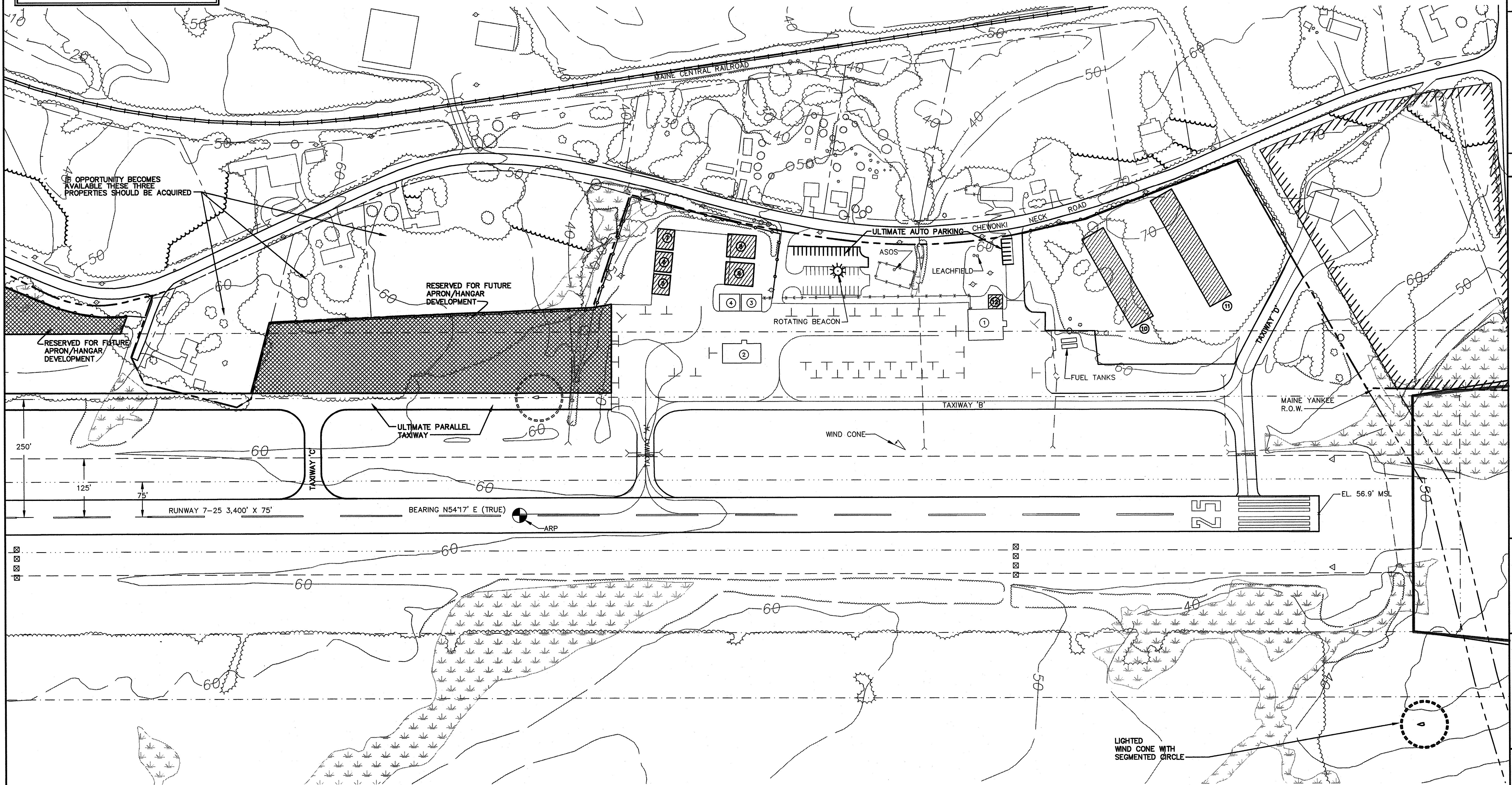

250'
125'
75'
RUNWAY 7-25 3,400' X 75'
BEARING N54°17' E (TRUE)

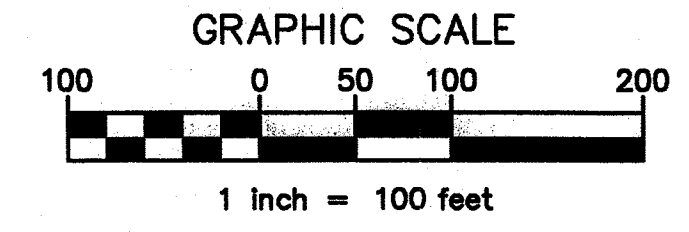

Portland, Maine
Tel: (207) 755-5811 • Fax: (207) 755-4545
www.dufresne-henry.com

Rev.	Description	By	Date

WISCASSET MUNICIPAL AIRPORT
AIP NO. 3-23-0068-07

MAINE

TERMINAL AREA PLAN

WISCASSET

Project No. 6180045	Proj. Manager JEG	Proj. Designer JEG	Drawn By MRS	Checked By JEG	Scale 1" = 100'	Approved DCD	Date 02-2001
---------------------	-------------------	--------------------	--------------	----------------	-----------------	--------------	--------------

Sheet 4 of 8

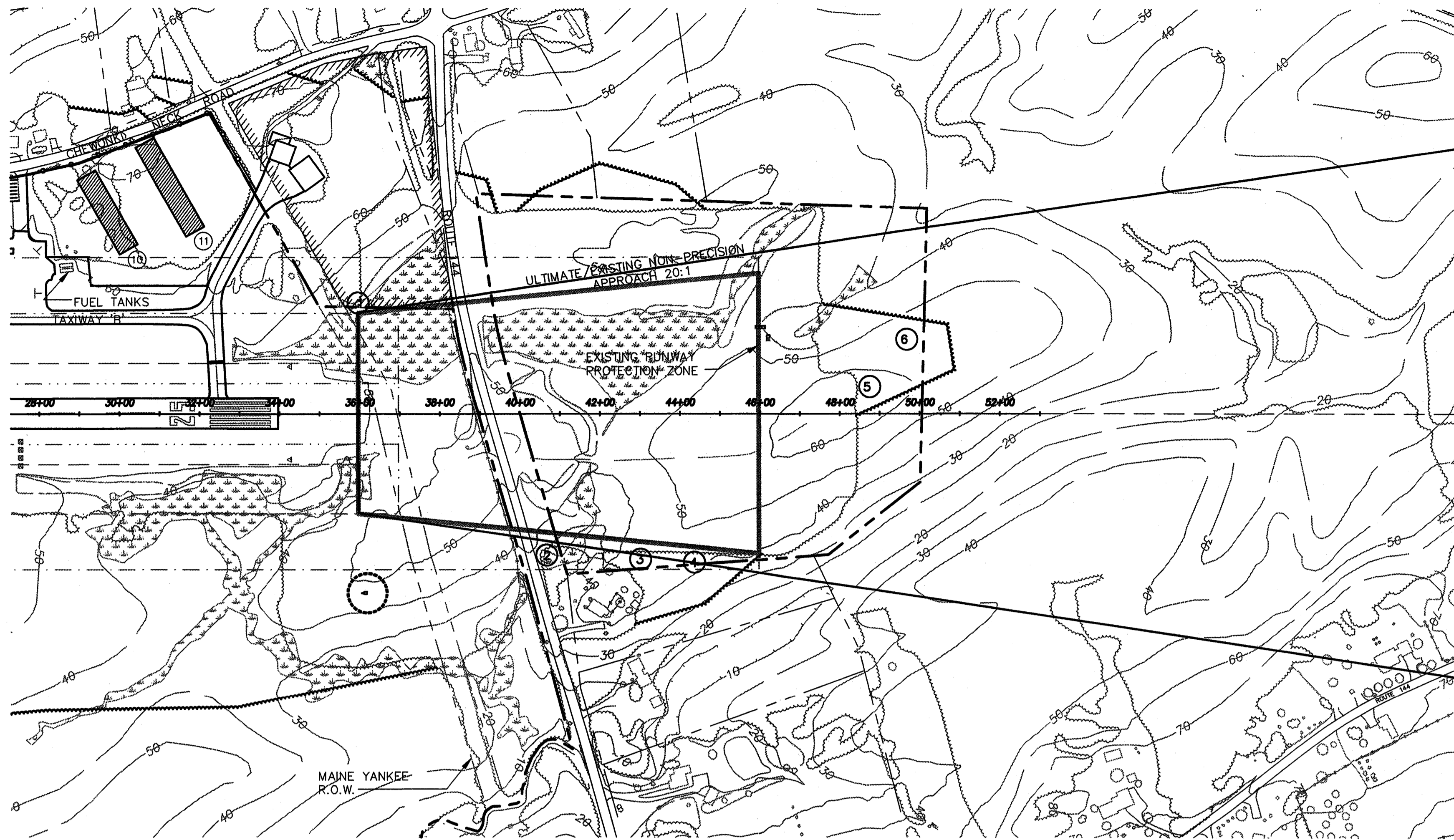

LEGEND	EXISTING	ULTIMATE
AIRPORT PROPERTY LINE	---	---
ABUTTERS' PROPERTY LINE	---	SAME
PAVEMENT	▨	▨
TREE LINE	~~~~~	~~~~~
AVIGATION EASEMENT LINE		SAME
FENCE LINE	—+—	—+—
BUILDINGS	▭	▭
UTILITY POLE	•	SAME
REIL	-	SAME
PAPI	□□□□	SAME
LIGHTED WIND CONE	○	○
LIGHTED WIND CONE SEGMENTED CIRCLE	○	○
OBJECT-FREE ZONE (OFZ)	---	SAME
OBJECT-FREE AREA (OFA)	---	SAME
RUNWAY SAFETY AREA (RSA)	---	SAME
BUILDING RESTRICTION LINE (BRL)	---	SAME
WETLANDS (DELINEATED)	~~~~~	SAME

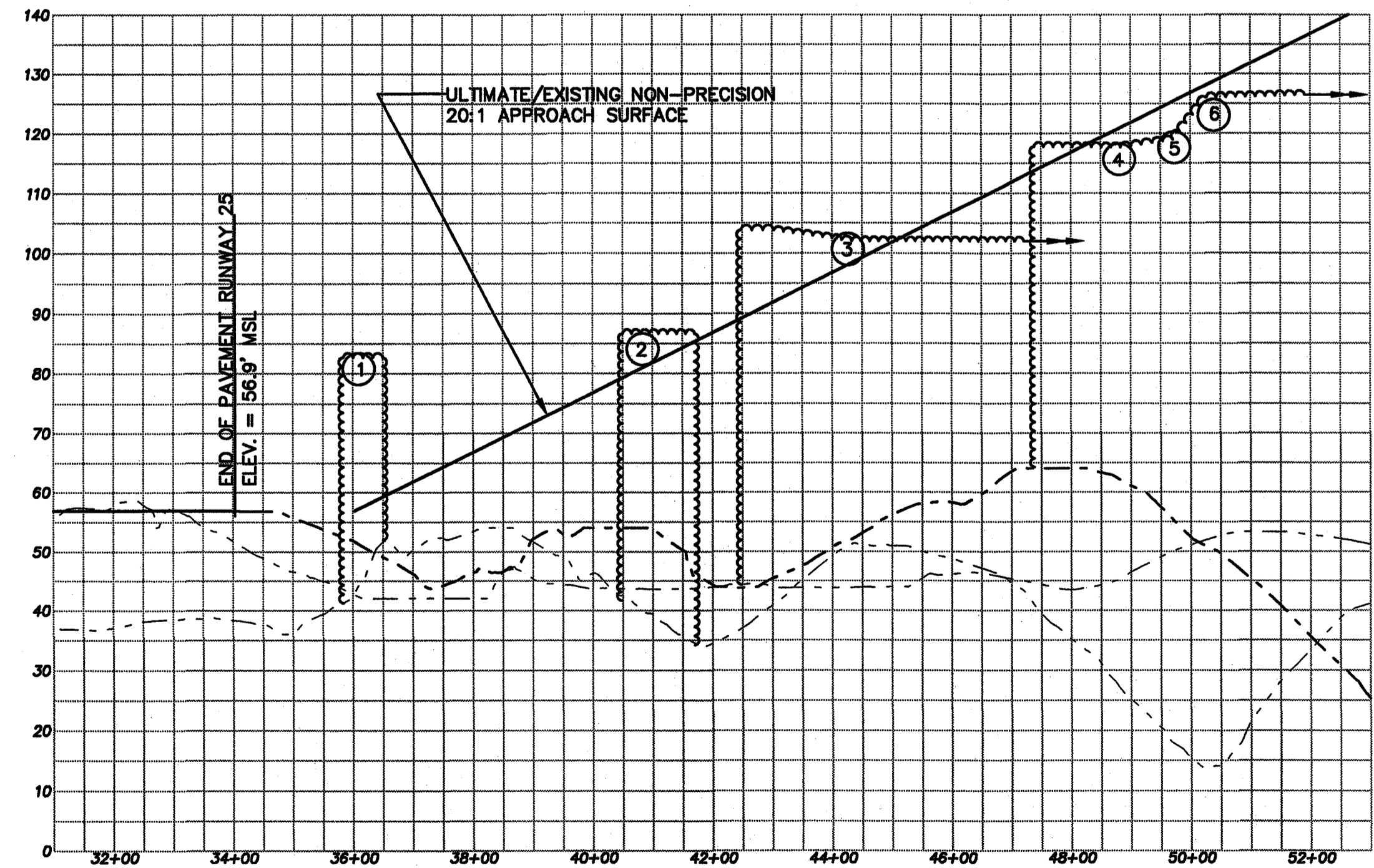
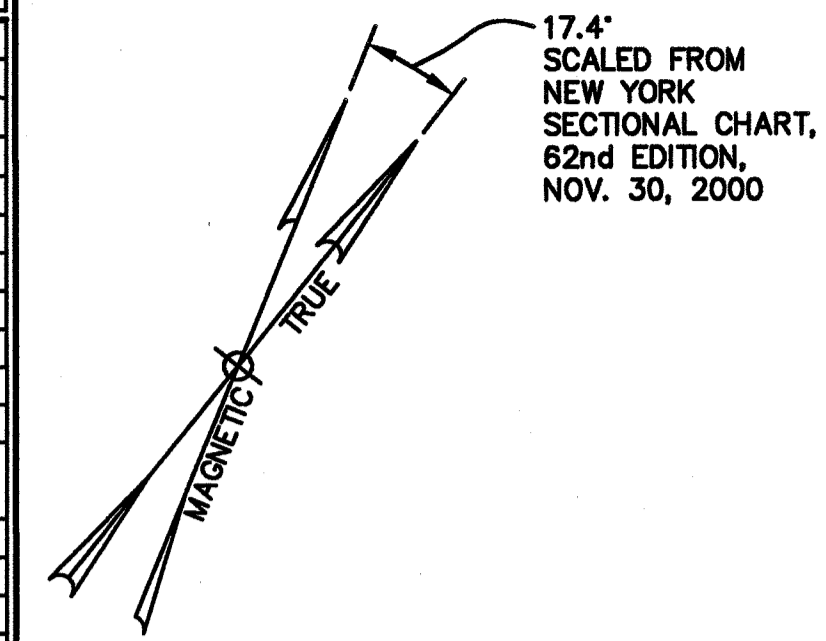

LEGEND	
CENTER OF APPROACH GROUND PROFILE	---
RIGHT EDGE OF APPROACH GROUND PROFILE	---
LEFT EDGE OF APPROACH GROUND PROFILE	---
VEGETATION WITHIN APPROACH SURFACE	~~~~~
BUILDING	▭

SCALE:
 HORIZONTAL: 1" = 200'
 VERTICAL: 1" = 20'

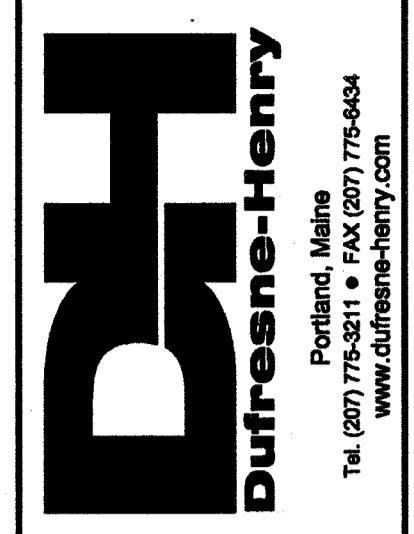

Rev.	Description	By	Date

WISCASSET MUNICIPAL AIRPORT
 AIP NO. 3-25-0049-07
RUNWAY 25 APPROACH PLAN AND PROFILE
 WISCASSET
 MAINE

Project No.	816005
Prof. Manager	JEG
Prof. Designer	JEG
Drawn By	MRS
Checked By	JEG
Scale	AS NOTED
Approved	DCD
Date	02-2001

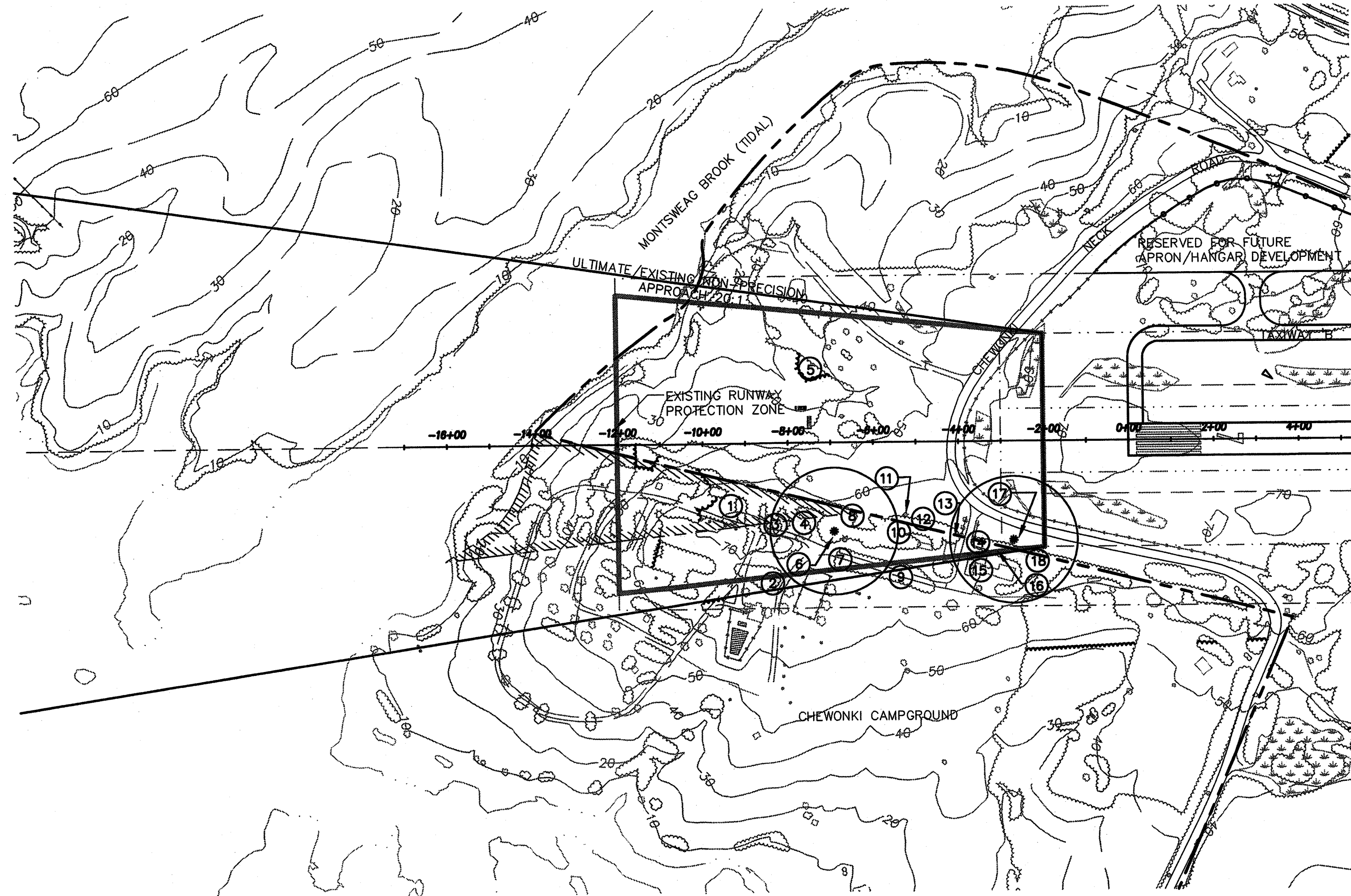

LEGEND	EXISTING	ULTIMATE
AIRPORT PROPERTY LINE	---	---
ADJUTERS' PROPERTY LINE	---	SAME
PAVEMENT	=====	=====
TREE LINE	~~~~~	~~~~~
AVIGATION EASEMENT LINE		SAME
FENCE LINE	-----	-----
BUILDINGS	■	■
UTILITY POLE	+	SAME
REIL	-	SAME
PAPI	□□□□	SAME
LIGHTED WIND CONE	○	○
SEGMENTED CIRCLE	○	○
OBJECT-FREE ZONE (OFZ)	---	SAME
OBJECT-FREE AREA (OFA)	---	SAME
RUNWAY SAFETY AREA (RSA)	---	SAME
BUILDING RESTRICTION LINE (BRL)	---	SAME
WETLANDS (DELINEATED)	~~~~~	SAME

17.4' SCALED FROM NEW YORK SECTIONAL CHART, 62nd EDITION, NOV. 30, 2000

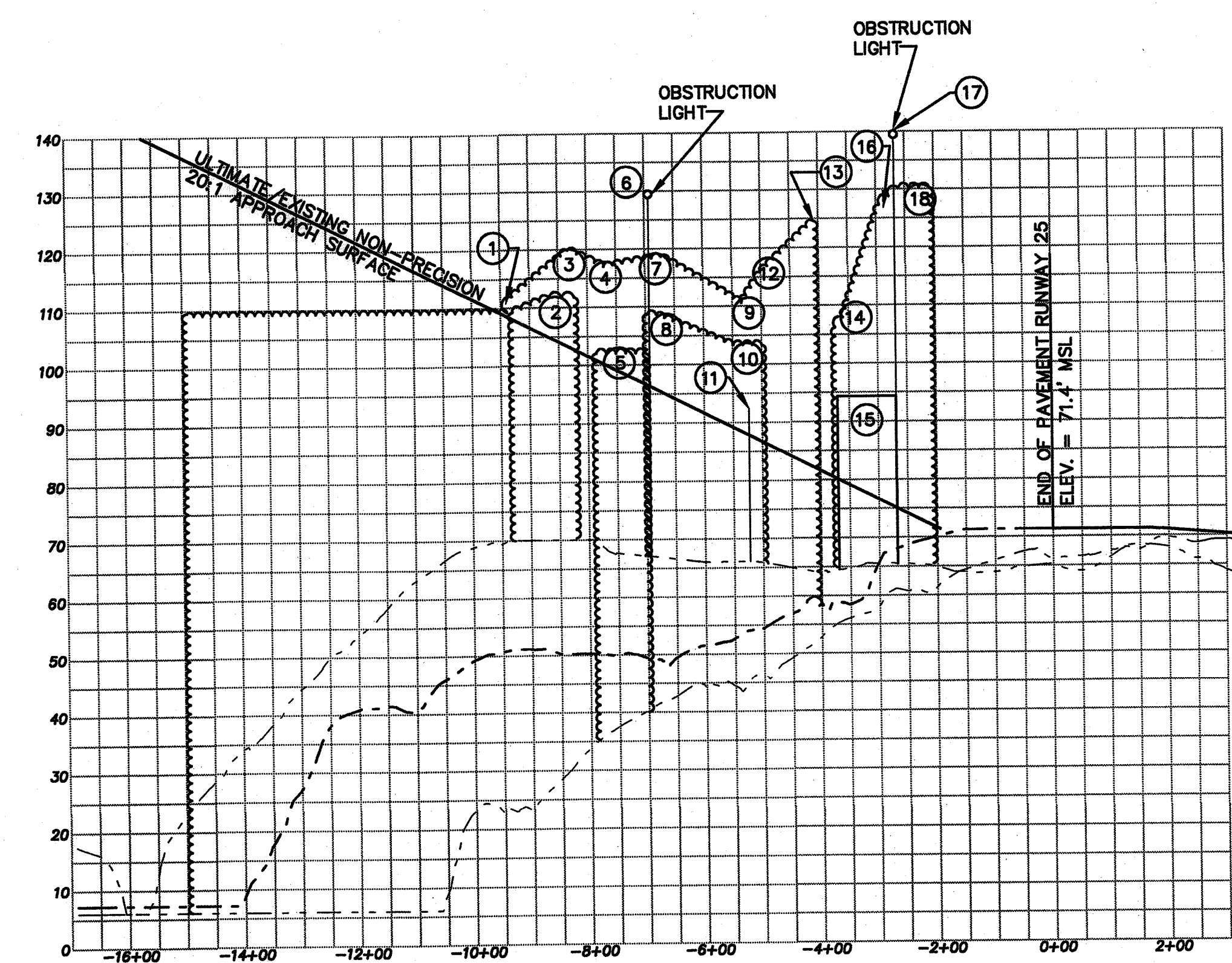

SCALE:
HORIZONTAL: 1" = 200'
VERTICAL: 1" = 20'

LEGEND	
CENTER OF APPROACH GROUND PROFILE	---
RIGHT EDGE OF APPROACH GROUND PROFILE	---
LEFT EDGE OF APPROACH GROUND PROFILE	---
VEGETATION WITHIN APPROACH SURFACE	~~~~~
BUILDING	■



Rev.	By	Date	Description

WISCASSET MUNICIPAL AIRPORT
AIP NO. 3-23-0048-07

RUNWAY 7 APPROACH PLAN AND PROFILE

WISCASSET

Project No.	8180045
Proj. Manager	JEG
Proj. Designer	JEG
Drawn By	MRS
Checked By	JEG
Scale	AS NOTED
Approved	DD
Date	02-2001

